



## King Street

Goldthorpe, Rotherham, S63 9LZ

£775



Located in the heart of Goldthorpe, Rotherham, this charming mid-terrace house on King Street offers a delightful blend of comfort and convenience. With three well-proportioned bedrooms, this property is ideal for families or those seeking extra space.

Situated in a vibrant community, residents will benefit from local amenities, schools, and transport links, making it an excellent choice for those who value accessibility. This property presents a wonderful opportunity for anyone looking to settle in a friendly neighbourhood while enjoying the comforts of a newly renovated home.

If you are a first time renter, this mid-terrace house on King Street is certainly worth considering.



## Description

Situated on a well-regarded street in Goldthorpe, this deceptively spacious three-bedroom mid-terraced home is an ideal first time renters. The location is practical and appealing being close to local amenities, schools, transport links and nearby green spaces. Goldthorpe continues to grow in popularity due to its affordability and ongoing regeneration, making this an excellent time to secure a property in the area.

### Lounge 14'3" x 13'4" (4.35m x 4.08m)

The property is entered through the front door into the lounge, with new carpet, radiator with TRV and wall mounted central heating controls.

### Kitchen 10'7" x 10'5" (3.25m x 3.19m)

The kitchen comprises of Cashmere coloured high gloss units, wood effect worktops, chrome splash back and extractor and stainless sink with an electric fan assisted oven and four ring electric hob. Space for a washing machine and fridge / freezer and vinyl flooring.

### Ground Floor Bathroom

The bathroom has a white three piece suite; bath with an electric shower over with a glass shower screen, wc and hand basin, vinyl flooring and aqua board walls.

### Bedroom One 14'4" x 11'10" (4.39m x 3.63m)

A double room front facing with carpet and radiator.

### Bedroom Two 13'0" x 10'11" (3.97m x 3.33m)

A rear facing double bedroom with carpet and radiator with access through to the third bedroom.

### Bedroom Three 9'11" x 8'10" (3.03m x 2.70m)

The third bedroom is entered through the second bedroom with carpet and radiator.

## Outside

A traditional terraced house rear concrete enclosed yard with gated rear access with outside electrics.

## Disclaimer

1. MONEY LAUNDERING REGULATIONS: Intending purchasers will be asked to produce identification documentation at a later stage and we would ask for your co-operation in order that there will be no delay in agreeing the sale.

2. General: While we endeavour to make our sales particulars fair, accurate and reliable, they are only a general guide to the property and, accordingly, if there is any point which is of particular importance to you, please contact the office and we will be pleased to check the position for you, especially if you are contemplating travelling some distance to view the property.

3. Measurements: These approximate room sizes are only intended as general guidance. You must verify the dimensions carefully before ordering carpets or any built-in furniture.

4. Services: Please note we have not tested the services or any of the equipment or appliances in this property, accordingly we strongly advise prospective buyers to commission their own survey or service reports before finalising their offer to purchase.

5. THESE PARTICULARS ARE ISSUED IN GOOD FAITH BUT DO NOT CONSTITUTE REPRESENTATIONS OF FACT OR FORM PART OF ANY OFFER OR CONTRACT. THE MATTERS REFERRED TO IN THESE PARTICULARS SHOULD BE INDEPENDENTLY VERIFIED BY PROSPECTIVE BUYERS OR TENANTS. NEITHER Tetris UK Sales & Lettings Limited NOR ANY OF ITS EMPLOYEES OR AGENTS HAS ANY AUTHORITY TO MAKE OR GIVE ANY REPRESENTATION OR WARRANTY WHATSOEVER IN RELATION TO THIS PROPERTY.

## Area Map



## Floor Plans

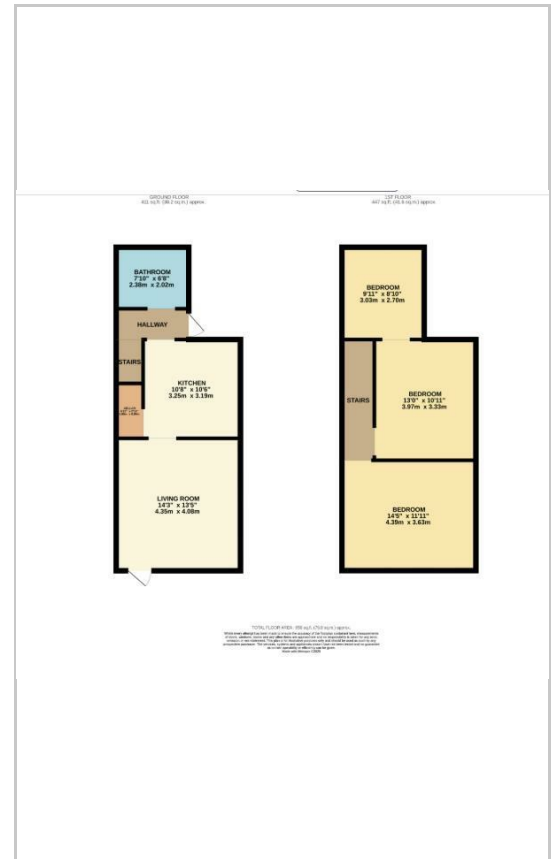

## Energy Efficiency Graph

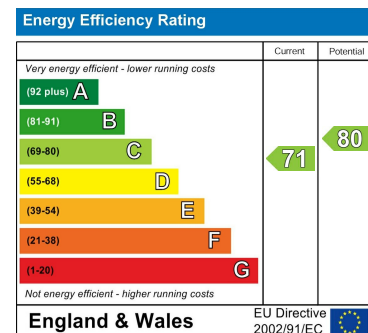

These particulars, whilst believed to be accurate are set out as a general outline only for guidance and do not constitute any part of an offer or contract. Intending purchasers should not rely on them as statements of representation of fact, but must satisfy themselves by inspection or otherwise as to their accuracy. No person in this firm's employment has the authority to make or give any representation or warranty in respect of the property.

14-16 Eldon Street, Tuxford, NG22 0LH

Tel: 01777 801 901 Email: dawn@clark-estates.co.uk www.clark-estates.co.uk